

PD9000-ENC ConsoliDator+ UL Type 4X Plastic & UL Type 4 Steel Enclosures

Data Sheet



PDA3939



PDA1939



PDA1909



PDA1939 with Light/Horn,
Button, and Stainless Steel
Sun Hood Accessories



PDA2929



PDA2919



PDA2909



Download free 3-D CAD files of these
enclosures to simplify your drawings!
predig.com/documentation-cad

FEATURES

- House One ConsoliDator+ PD9000
- Cutout for One ConsoliDator+ Provided
- ConsoliDator+ Mounts in Cover
- Sub-Panels Available
- PDA6909-SS Pipe Mounting Kit Available
- Light/Horn & Button Available
- Stainless Steel Sun Hood Available
- Enclosure Ventilation Kit Available

Steel Enclosures

- 14-Gauge Steel
- UL Type / NEMA 4, 12 and 13
- Cover Secured with Screwed Latches
- Built-In Mounting Flanges with Holes
- UL Listed, CSA Certified

Plastic Enclosures

- UL Type / NEMA 4X
- Cover Secured with Hasps
- Clear Hinged Door Fully Encloses ConsoliDator+ (PDA3939 only)
- ConsoliDator+ Mounts in Hinged Sub-Panel Door (PDA3939 only)
- Mounting Hardware Provided
- UL Listed

OVERVIEW

The PD9000-ENC enclosures provide a convenient way to mount the PD9000 ConsoliDator+ to walls, pipes, and other vertical structures. The enclosures are available in painted steel and plastic and come pre-cut with one cutout to mount the PD9000.

The enclosures are available in various sizes, with the larger enclosures capable of housing other pieces of equipment, such as PDA1024-01 power supply.

A pipe mounting kit is available to mount the enclosure to a 2-inch pipe and a stainless steel sun hood accessory is available for outdoor installations.

In addition, the enclosures can be ordered with holes predrilled for mounting devices such as the PDA-LH Light/Horn, PDA-BUTTON Button, and the PDA0007 Ventilation Kit to the enclosure.

The enclosure and ConsoliDator+ are ordered and packaged separately.

PRECISION DIGITAL CORPORATION

**PRECISION
DIGITAL**
www.predig.com

WALL MOUNTING

Wall Mounting for Steel Enclosures

The PDA2909, PDA2919, and PDA2929 steel enclosures come with built-in mounting flanges located on the backside at the top and bottom of the enclosure. These allow for easy and convenient wall mounting.



Steel enclosures have built-in flanges on the back side for wall mounting

Wall Mounting for Plastic Enclosures

The PDA1909, PDA1939, and PDA3939 plastic enclosures include four mounting flanges and four screws for your convenience. Using the included screws and a Phillips head screwdriver simply assemble each flange in the four threaded screw holes on the back of the enclosure as shown in the example below. Now the enclosure is ready to be easily mounted to a wall.

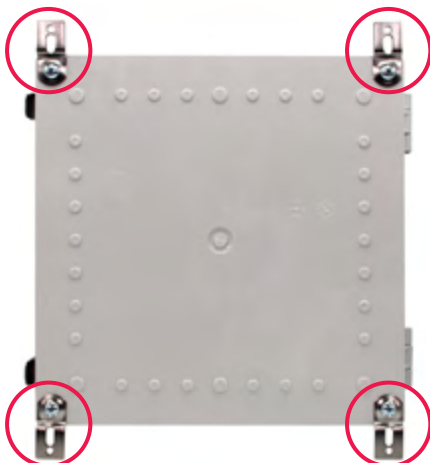

Plastic enclosures are supplied with 4 screws and 4 mounting flanges

PIPE MOUNTING

PDA6909-SS Pipe Mounting Kit

The ConsoliDator+ enclosures can be mounted on a 2" pipe with the PDA6909-SS pipe mounting kit. The PDA6909-SS comes with all the hardware you need to conveniently mount the mounting plate to the enclosure and the enclosure to the pipe. The mounting kit is made of stainless steel and is compatible with both plastic and steel ConsoliDator+ enclosures.



PDA1939 enclosure mounted to 2" pipe with PDA6909-SS pipe mounting kit

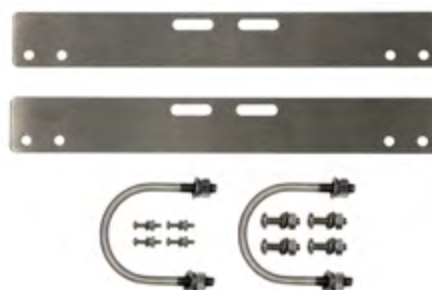

PDA6909-SS stainless steel pipe mounting kit contents

COVER SECURING METHOD

Plastic Enclosures

The covers on the plastic enclosures are hinged and secured with hasps.



PDA1909 plastic enclosure showing hasps

Steel Enclosures

The covers on the steel enclosures are hinged and secured with latches and screws.

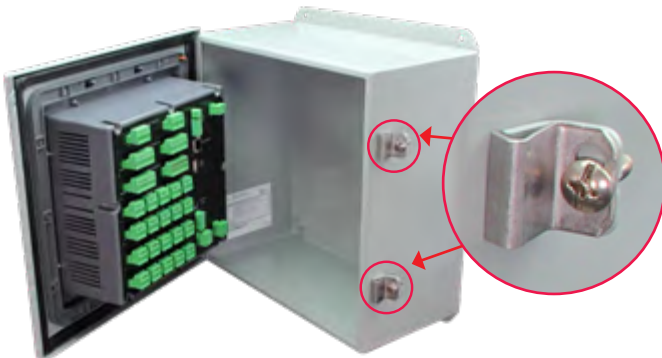

PDA2909 steel enclosure showing latches and screws

PDA3939 Fully Protects ConsoliDator+

The PDA3939 enclosure fully protects the ConsoliDator+ from the outside elements. The controller is mounted in a hinged interior plate and is covered and secured by the clear plastic outer door and hasps.



PDA3939 plastic enclosure open with clear cover and interior door for mounting ConsoliDator+

MODELS AVAILABLE

UL Type 4X / NEMA 4X Plastic Enclosures



PDA1909



PDA1939



PDA3939

UL Type 4 / NEMA 4 Steel Enclosures



PDA2909



PDA2919



PDA2929



Download free 3-D CAD files of these enclosures to simplify your drawings!

predig.com/documentation-cad

ACCESSORIES

Sub-Panels

Precision Digital offers plastic and steel sub-panels for the ConsoliDator+ enclosures that provide a convenient way to mount additional items to the base of the enclosure. They can be drilled to accept screws for easy mounting of relays, contactors, securing wiring clips, or installing other internal devices.

Sub-Panels for Plastic Enclosure

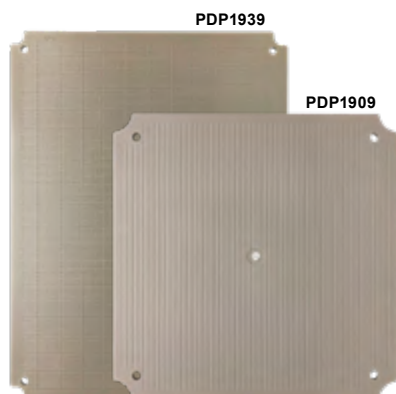

SPECIFICATIONS

Sub-panel	Enclosure	Dimensions (Inches)	Dimensions (mm)
PDP1909	PDA1909	10.3 × 10.3	262 × 262
PDP1939	PDA1939, PDA3939	12.0 × 16.0	306 × 407

Material: Plastic
Mounting hardware is included.

Sub-Panels for Steel Enclosures

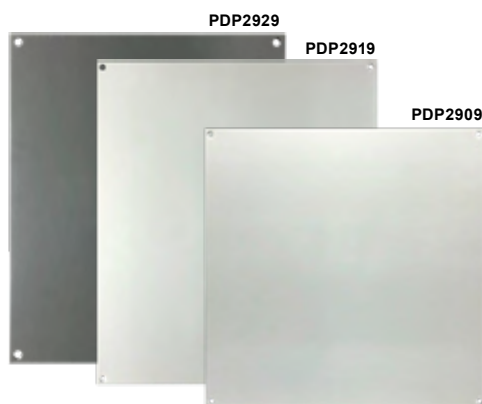

SPECIFICATIONS

Sub-panel	Enclosure	Dimensions (Inches)	Dimensions (mm)
PDP2909	PDA2909	11.0 × 11.0	279 × 279
PDP2919	PDA2919	13.0 × 11.0	330 × 279
PDP2929	PDA2929	15.0 × 13.0	381 × 330

Thickness: 14 gauge
Material: Steel
Mounting hardware is included.

PDA0007 Enclosure Ventilation Kit

The PDA0007 ventilation kit consists of two vents and is designed to equalize internal / external pressure and temperature to prevent condensation from building up in the enclosure. Internal baffles within the vents create an airflow pattern that allows air to pass between the inside of the enclosure and the outside environment. The vents are compatible for use with steel or plastic enclosures and are rated UL & CSA Type 4X and IP66. The ventilation kit can also be ordered as a MODVENT-P for plastic enclosures and a MOD-VENT-M for steel enclosures. When this is done, the accompanying enclosure will be provided with pre-drilled holes for the vents (Installation is done by the user and the enclosure is sold separately). See ordering information.

- Prevents condensation inside the enclosure
- UL & CSA Type 4X IP66
- Use with steel or plastic enclosures
- For wall thickness of 16 gauge to 1/4"
- Corrosion resistant polycarbonate
- Comes with two vents



PDA1024-01 24 VDC Power Supply for DIN Rail



The PDA1024-01 is a DIN rail mounted 1.5 A, 24 VDC power supply that can be used for a variety of functions; the most common of which is powering 4-20 mA transmitters.

SPECIFICATIONS

Output Voltage: 21.6-29 VDC; ±10% 1.5A rated current.
Dimensions: 1.40" x 3.50" x 2.10"
(35 mm x 90 mm x 54.5 mm) (W x H x D)

ACCESSORIES (CONTINUED)

Light/Horn & Button Mounted to Enclosure

Transform Precision Digital meters and controllers housed in an enclosure into an efficient display, control, and alarm system with the MOD-LH series. It provides a light/horn to boost visibility of alarm conditions, a button that connects to the meter's digital input to control or reset the alarms, and hole drilling on the enclosure for both the light/horn and button to make user installation and wiring quick and easy. Enclosure and meter are sold separately.

The MOD-LH series is compatible with a wide range of Precision Digital UL Type / NEMA 4 & 4X enclosures as well as meters and controllers including the ProVu, Trident, Loop Leader, and ConsoliDator+ Series.

Overall, the MOD-LH series is a simple solution for Precision Digital meters and controllers that adds audible and visual ways to indicate critical alarms.

What's Included

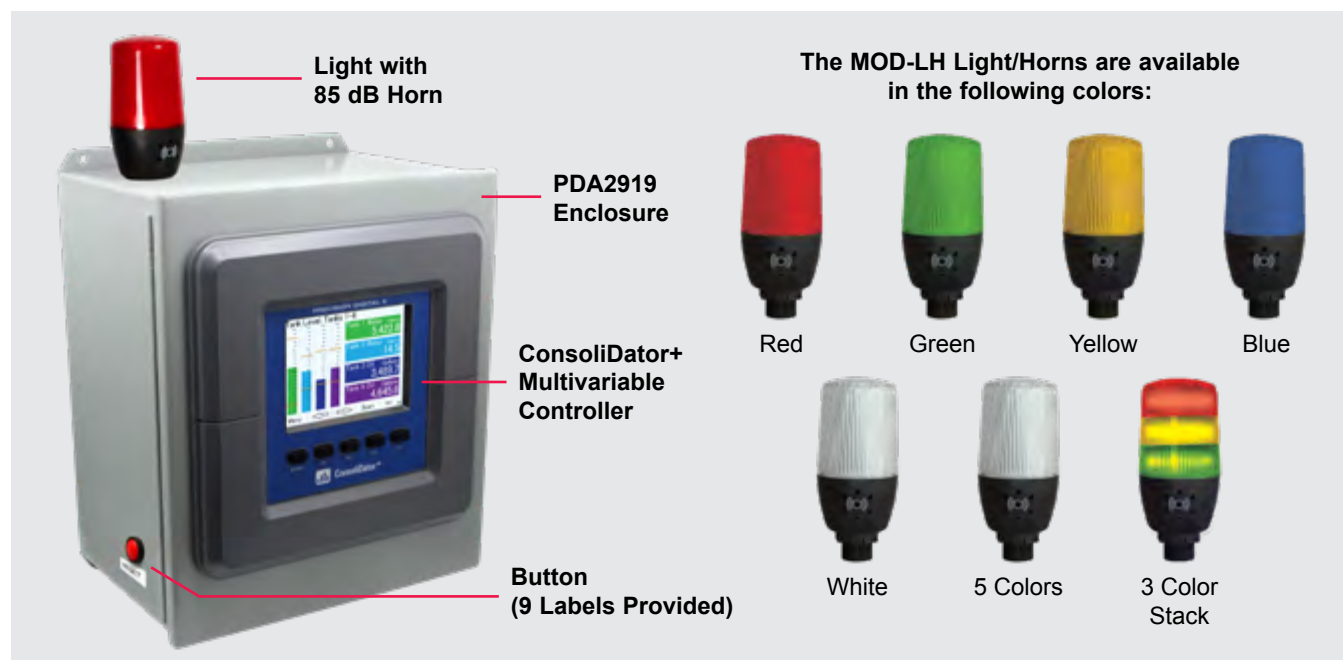
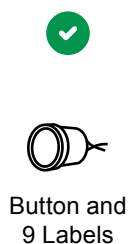

ACCESSORIES (CONTINUED)

PDA9000SH Stainless Steel Sun Hood for ConsoliDator+ Multivariable Controller

The PDA9000SH Stainless Steel Sun Hood improves the readability of the PD9000 ConsoliDator+ Multivariable Controller when it is mounted in direct sunlight by shading the instrument from the sun. The Sun Hood is made from 18 gauge 316 stainless steel and mounts between the PD9000 controller and the enclosure cover/door. In addition, the attached gasket is installed between the Sun Hood and the enclosure cover/door to provide a NEMA 4X seal. The whole assembly is held in place by the 12 mounting screws provided with the ConsoliDator+ Controller.

SPECIFICATIONS

Material	18 gauge 316 stainless steel
Overall Dimensions	11.04" x 11.08" x 6.15" (280 mm x 281 mm x 155 mm) (W x H x D)
Weight	3.4 lb (1.5 kg)
Gasket Material	Silicone Foam

DIMENSIONS

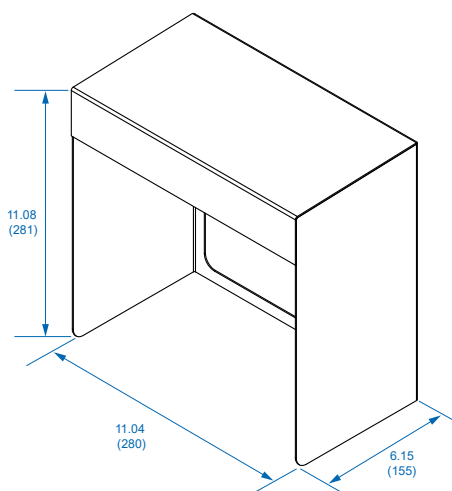

PDA9000SH Overall Dimensions

Units: Inches (mm)

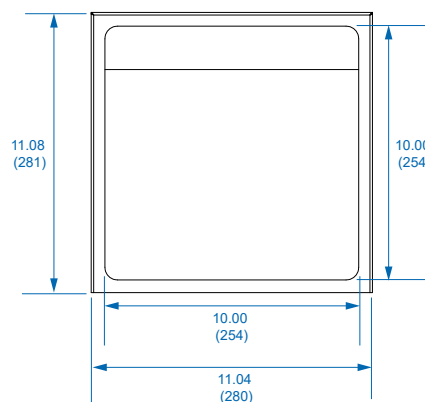

PDA9000SH ConsoliDator+ Cutout

The following ConsoliDator+ Enclosures are compatible with the PDA9000SH Sun Hood:



PDA1909
UL Type 4X Plastic



PDA1939
UL Type 4X Plastic



PDA2909
UL Type 4 Steel



PDA2919
UL Type 4 Steel



PDA2929
UL Type 4 Steel

Note: The PDA3939 ConsoliDator+ Enclosure is not compatible with the PDA9000SH

SPECIFICATIONS

Plastic Enclosure Specifications (PDA1909, PDA1939, PDA3939)

Material: Thermoplastic Polyester Enclosure with Stainless Steel Hardware. PDA3939 only: Cover: Clear polycarbonate plastic; Plate: Painted Aluminum

Color: Gray

Controller Mounting Method:

PDA1909 & PDA1939: Through cover

PDA3939: Through interior hinged plate

Cover Mounting Method: Hinge / Hasp

Ratings: UL Type / NEMA 4X

Approvals: UL/C-UL

Operating Temperature: -40 to 120°C

Dimensions:

PDA1909: 11.8" x 11.8" x 5.9"

(300 mm x 300 mm x 150 mm) (H x W x D)

PDA1939: 17.7" x 13.8" x 7.9"

(450 mm x 350 mm x 200 mm) (H x W x D)

PDA3939: 17.7" x 13.8" x 7.9"

(450 mm x 350 mm x 200 mm) (H x W x D)

Weight:

PDA1909: 3.1 lbs (1.4 kg)

PDA1939: 6.4 lbs (2.9 kg)

PDA3939: 8.6 lbs (3.9 kg)

Warranty: 1 year

Steel Enclosure Specifications (PDA2909, PDA2919, PDA2929)

Material: Painted Steel

Color: Gray

Controller Mounting Method: Through cover

Cover Mounting Method: Hinge / Screw

Ratings: UL Type / NEMA 4, 12, 13

Approvals: CSA, UL/C-UL

Operating Temperature: -40 to 120°C

Dimensions:

PDA2909: 12.0" x 12.0" x 6.0"

(305 mm x 305 mm x 152 mm) (H x W x D)

PDA2919: 14.0" x 12.0" x 8.0"

(356 mm x 305 mm x 203 mm) (H x W x D)

PDA2929: 16.0" x 14.0" x 10.0"

(406 mm x 355 mm x 254 mm) (H x W x D)

Weight:

PDA2909: 11.6 lbs (5.3 kg)

PDA2919: 15.6 lbs (7.1 kg)

PDA2929: 21.9 lbs (9.9 kg)

Warranty: 1 year

DIMENSIONS

PDA1909 Plastic Enclosure

Units: Inches (mm)

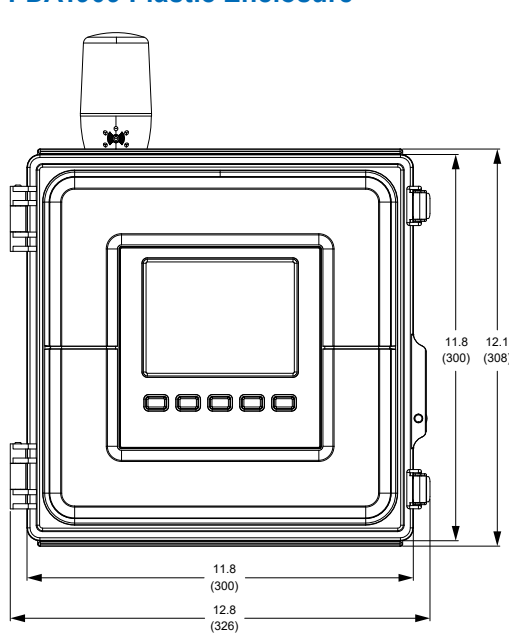

Front View

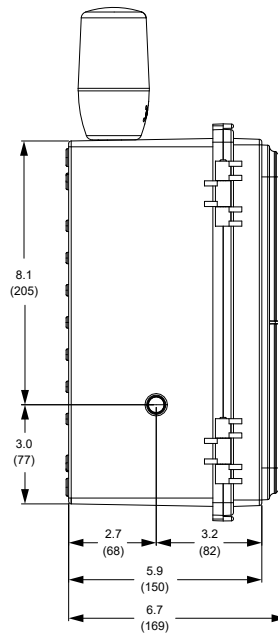

Side View

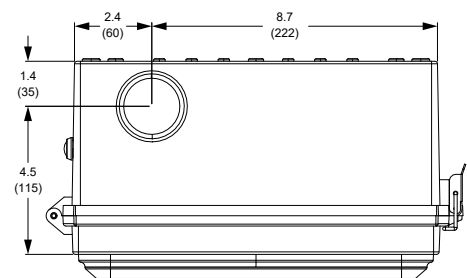

Top View

PDA1939 Plastic Enclosure

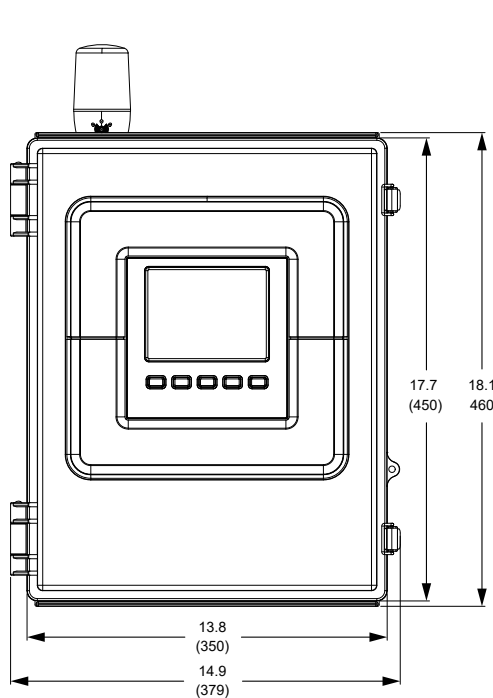

Front View

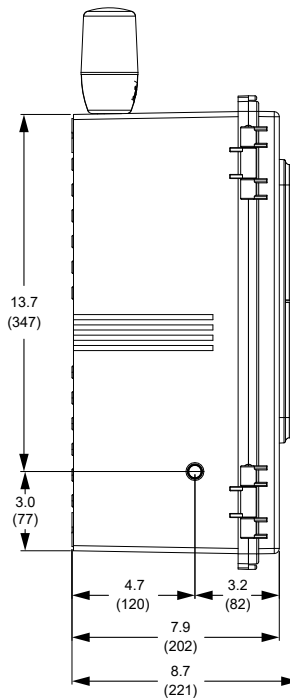

Side View

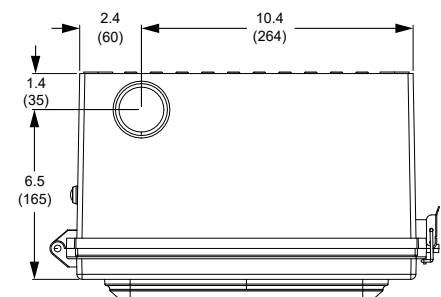

Top View

Notes:

1. Enclosure shown with optional Light/Horn and Button.
2. Holes for the Light/Horn and Button are only present when MOD-LH is ordered.



Download free 3-D CAD files of these enclosures to simplify your drawings!

predig.com/documentation-cad

PDA3939 Plastic Enclosure

Units: Inches (mm)

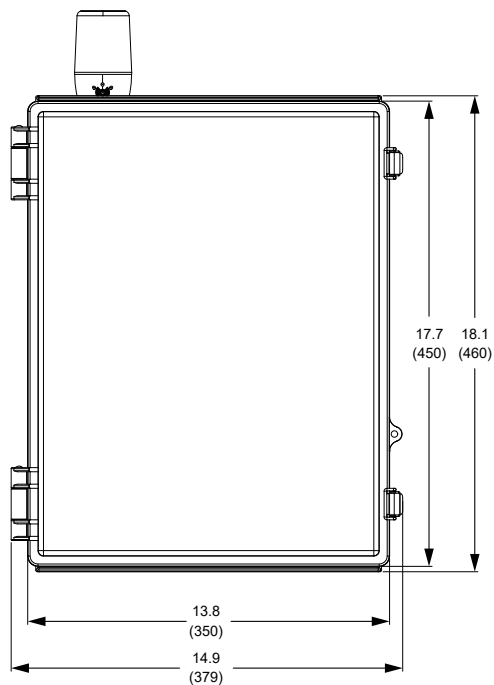

Front View

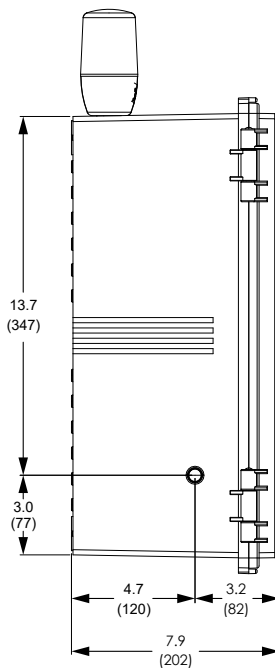

Side View

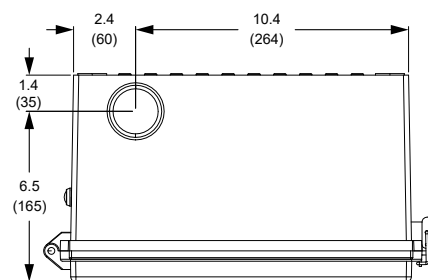

Top View

PDA2909 Steel Enclosure

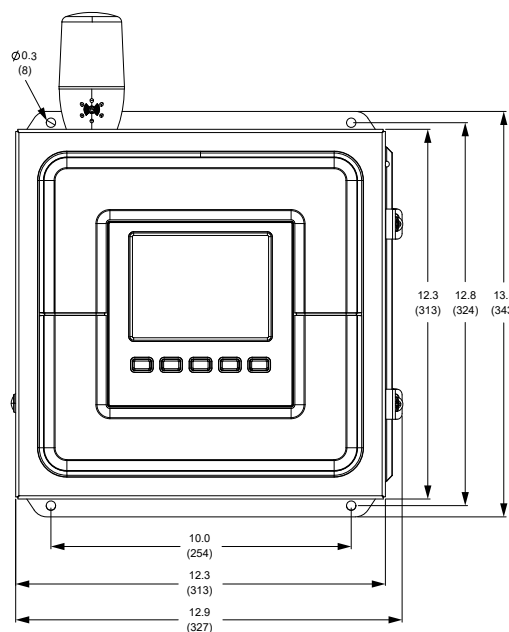

Front View

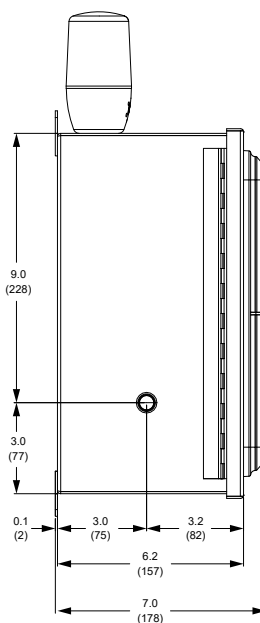

Side View

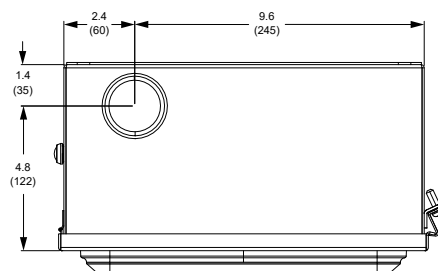

Top View

Notes:

1. Enclosure shown with optional Light/Horn and Button.
2. Holes for the Light/Horn and Button are only present when MOD-LH is ordered.



Download free 3-D CAD files of these enclosures to simplify your drawings!

predig.com/documentation-cad

PDA2919 Steel Enclosure

Units: Inches (mm)

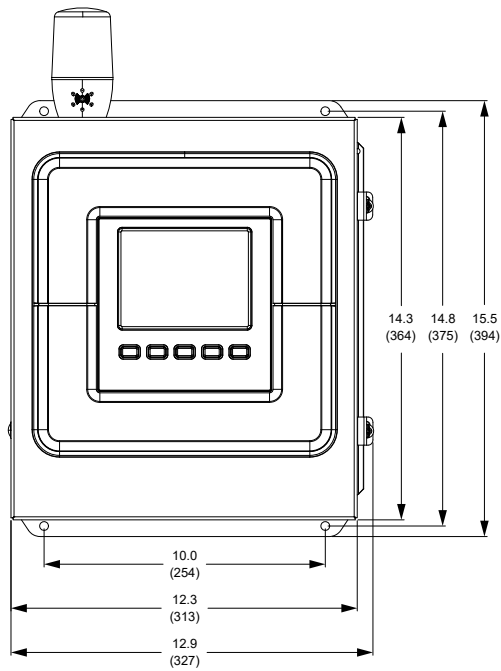

Front View

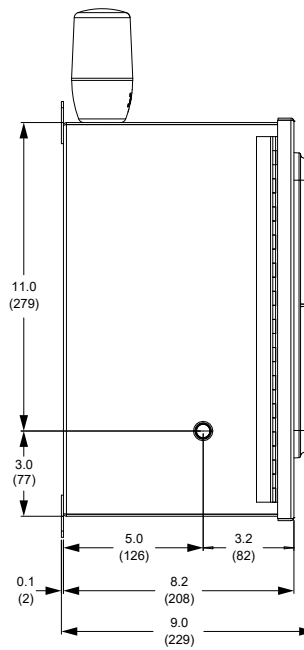

Side View

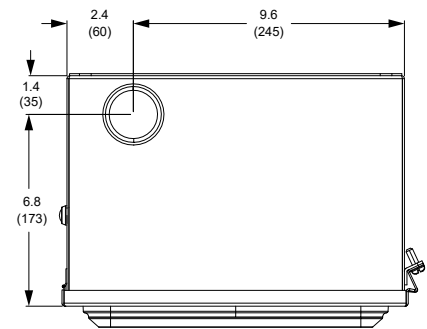

Top View

PDA2929 Steel Enclosure

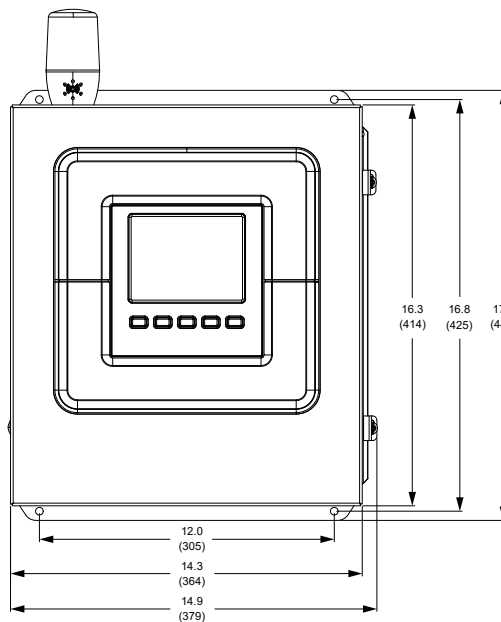

Front View

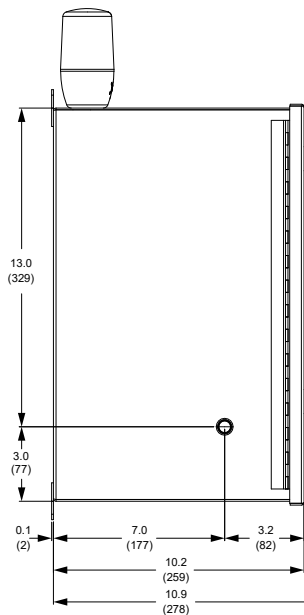

Side View

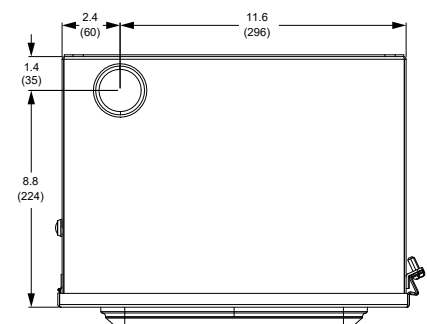

Top View

Notes:

1. Enclosure shown with optional Light/Horn and Button.
2. Holes for the Light/Horn and Button are only present when MOD-LH is ordered.



Download free 3-D CAD files of these enclosures to simplify your drawings!

predig.com/documentation-cad

ORDERING INFORMATION

Enclosures

Model	Description
PDA1909	Plastic Enclosure for One ConsoliDator+ Dimensions: 11.8" x 11.8" x 5.9" (300 mm x 300 mm x 150 mm) (H x W x D)
PDA1939	Plastic Enclosure for One ConsoliDator+ Dimensions: 17.7" x 13.8" x 7.9" (450 mm x 350 mm x 200 mm) (H x W x D)
PDA2909	Steel Enclosure for One ConsoliDator+ Dimensions: 12.0" x 12.0" x 6.0" (305 mm x 305 mm x 152 mm) (H x W x D)
PDA2919	Steel Enclosure for One ConsoliDator+ Dimensions: 14.0" x 12.0" x 8.0" (356 mm x 305 mm x 203 mm) (H x W x D)
PDA2929	Steel Enclosure for One ConsoliDator+ Dimensions: 16.0" x 14.0" x 10.0" (406 mm x 355 mm x 254 mm) (H x W x D)
PDA3939	Plastic Enclosure with Clear Cover for One ConsoliDator+ Dimensions: 17.7" x 13.8" x 7.9" (450 mm x 350 mm x 200 mm) (H x W x D)

All enclosures come with (1) cutout for (1) ConsoliDator+ controller.

Sub-Panels

Model	Description
PDP1909	Plastic Sub-Panel for PDA1909
PDP1939	Plastic Sub-Panel for PDA1939 and PDA3939
PDP2909	Steel Sub-Panel for PDA2909
PDP2919	Steel Sub-Panel for PDA2919
PDP2929	Steel Sub-Panel for PDA2929

Accessories

Model	Description
MOD-VENT-M	Vents (2) for Metal ConsoliDator+ Enclosure with Holes Drilled for Vents in Enclosure. Enclosure sold separately and assembly required by user.
MOD-VENT-P	Vents (2) for Plastic ConsoliDator+ Enclosure with Holes Drilled for Vents in Enclosure. Enclosure sold separately and assembly required by user.
PDA0007	Ventilation Kit for ConsoliDator+ Enclosures (Includes 2 Vents)
PDA1002	6" DIN Rail Mounting Kit
PDA1024-01	24 VDC Power Supply for DIN Rail
PDA6909-SS	Stainless Steel Pipe Mounting Kit
PDA9000SH	ConsoliDator+ Sun Hood
PDA-SSTAG	Stainless Steel Tag



WARNING

Cancer and Reproductive Harm - www.P65Warnings.ca.gov

Light/Horn Accessories

Model	Description
MOD-BUTTON1B-P	IP67 Blue Pushbutton with Hole Drilled in Plastic Enclosure
MOD-BUTTON1B-S	IP67 Blue Pushbutton with Hole Drilled in Steel Enclosure
MOD-BUTTON1G-P	IP67 Green Pushbutton with Hole Drilled in Plastic Enclosure
MOD-BUTTON1G-S	IP67 Green Pushbutton with Hole Drilled in Steel Enclosure
MOD-BUTTON1R-P	IP67 Red Pushbutton with Hole Drilled in Plastic Enclosure
MOD-BUTTON1R-S	IP67 Red Pushbutton with Hole Drilled in Steel Enclosure
MOD-LHRB1	Red Light/Horn and Button with Holes Drilled in Enclosure ⁽¹⁾
MOD-LHGB1	Green Light/Horn and Button with Holes Drilled in Enclosure ⁽¹⁾
MOD-LHYB1	Yellow Light/Horn and Button with Holes Drilled in Enclosure ⁽¹⁾
MOD-LHBB1	Blue Light/Horn and Button with Holes Drilled in Enclosure ⁽¹⁾
MOD-LHWB1	White Light/Horn and Button with Holes Drilled in Enclosure ⁽¹⁾
MOD-LH5CB1	Light/Horn with User Choice of Red, Green, Yellow, Blue or White Light, Button, and Holes Drilled in Enclosure ⁽¹⁾
MOD-LH3LCB1-RYG	Light Stack/Horn with Red, Yellow, Green Lights, Button, and Holes Drilled in Enclosure ⁽¹⁾

Note:

- When a MOD-LH is ordered, enclosure comes pre-drilled with holes for Light/Horn and Button to be installed by user. Meter / controller and enclosure are sold separately. The Light/Horn hole is located on the top in the back left corner of the enclosure and the button hole is on the left side of the enclosure. **For mounting in different locations, order items separately and drill holes and mount as desired.**

Your Local Distributor is:

Disclaimer

The information contained in this document is subject to change without notice. Precision Digital Corporation makes no representations or warranties with respect to the contents hereof, and specifically disclaims any implied warranties of merchantability or fitness for a particular purpose.

©2024 Precision Digital Corporation. All rights reserved.

LDS9000-ENC_D 11/24