

 **WARNING**

To avoid unpredictable system behavior that can cause personal injury and property damage:

- Disconnect electrical supply (when necessary) before installation, servicing, or conversion.
- Disconnect air supply and depressurize all air lines connected to this product before installation, servicing, or conversion.
- Operate within the manufacturer's specified pressure, temperature, and other conditions listed in these instructions.
- Medium must be moisture-free if ambient temperature is below freezing.
- Service according to procedures listed in these instructions.
- Installation, service, and conversion of these products must be performed by knowledgeable personnel who understand how pneumatic products are to be applied.
- After installation, servicing, or conversion, air and electrical supplies (when necessary) should be connected and the product tested for proper function and leakage. If audible leakage is present, or the product does not operate properly, do not put into use.
- Warnings and specifications on the product should not be covered by paint, etc. If masking is not possible, contact your local representative for replacement labels.

 **WARNING**

**FAILURE OR IMPROPER SELECTION OR IMPROPER USE OF THE PRODUCTS AND/OR SYSTEMS DESCRIBED HEREIN OR RELATED ITEMS CAN CAUSE DEATH, PERSONAL INJURY AND PROPERTY DAMAGE.**

This document and other information from Parker Hannifin Corporation, its subsidiaries and authorized distributors provide product and/or system options for further investigation by users having technical expertise. It is important that you analyze all aspects of your application, including consequences of any failure and review the information concerning the product or systems in the current product catalog. Due to the variety of operating conditions and applications for these products or systems, the user, through its own analysis and testing, is solely responsible for making the final selection of the products and systems and assuring that all performance, safety and warning requirements of the application are met.

The products described herein, including without limitation, product features, specifications, designs, availability and pricing, are subject to change by Parker Hannifin Corporation and its subsidiaries at any time without notice.

**EXTRA COPIES OF THESE INSTRUCTIONS ARE AVAILABLE FOR INCLUSION IN EQUIPMENT / MAINTENANCE MANUALS THAT UTILIZE THESE PRODUCTS. CONTACT YOUR LOCAL REPRESENTATIVE.**

 **WARNING**

Air exhausting from one valve into the exhaust gallery of the manifold assembly may momentarily pressurize other valve circuits open to the same gallery. Design the circuit such that there is no hazard or consequence of damage from this action.

**Safety Guide**

For more complete information on recommended application guidelines, see the Safety Guide section of Pneumatic Division catalogs or you can download the **Pneumatic Division Safety Guide** at: [www.parker.com/safety](http://www.parker.com/safety)

**Introduction**

Follow these instructions when installing, operating, or servicing the product.

**Application Limits**

These products are intended for use in general purpose compressed air systems only. Compliance with the rated pressure, temperature, and voltage is necessary.

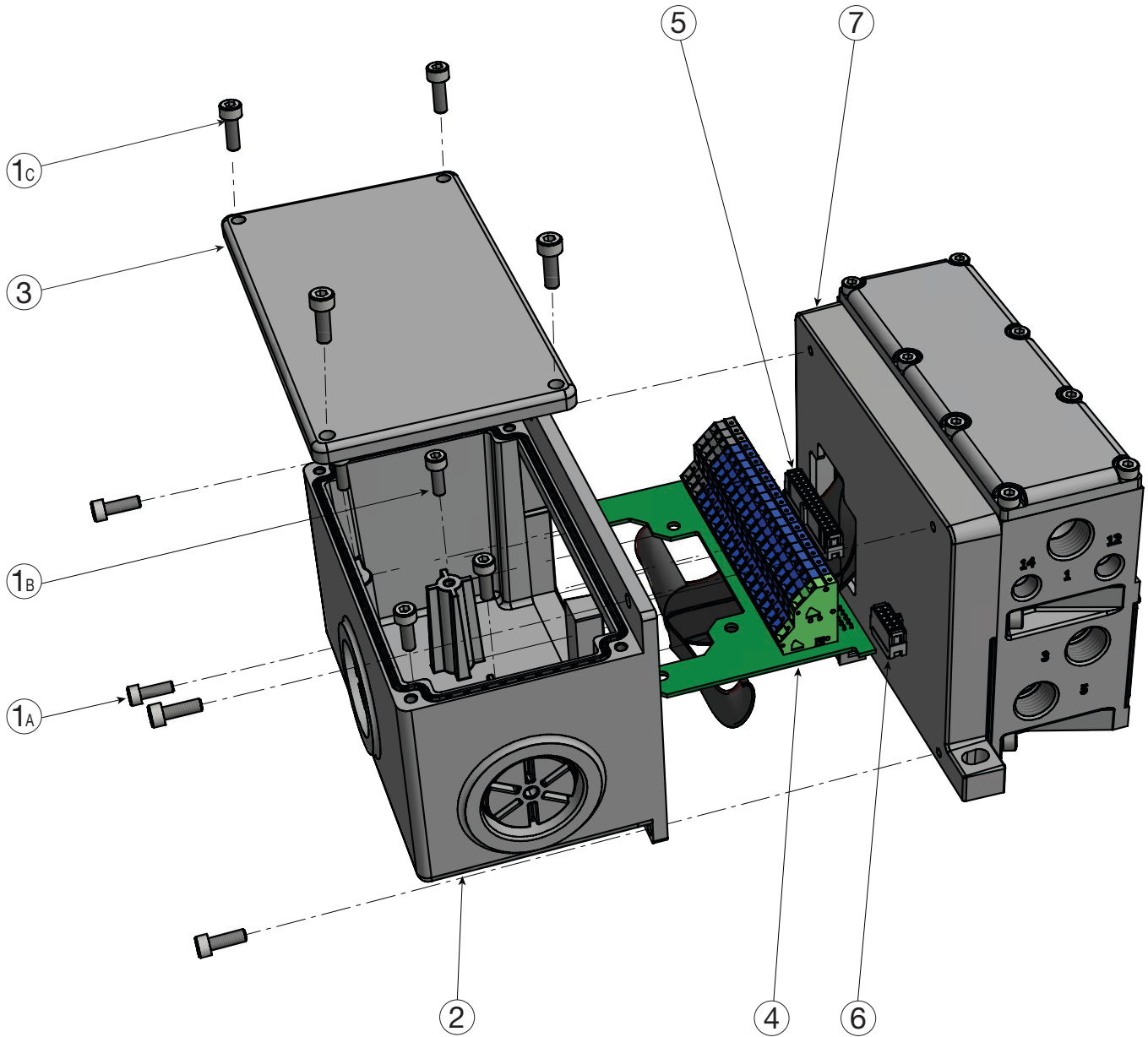

Item Number	Description	Quantity
1A, 1B, 1C	M4 x 12mm Screw	12
2	Terminal Box	1
3	Terminal Box Cover	1
4	Terminal PCB	1
5	30-Pin Ribbon Cable	1
6	10-Pin Ribbon Cable	1
7	Left Endplate Kit	1

NOTE: Refer to this table for all sheets.

**Assembly Techniques**

1. Remove cover (Item 3) from the top of the box
2. Remove bag of M4 screws (Item 1c) from the box and set aside

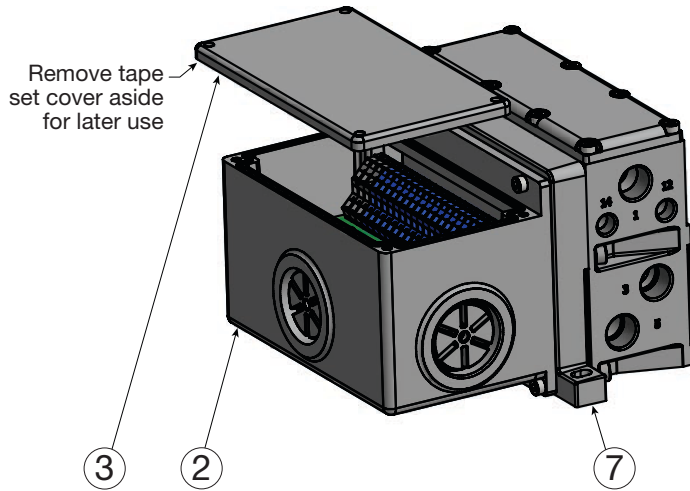
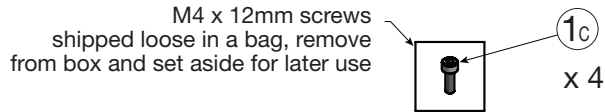

**CAUTION:**  
Take care to not damage the PC Board while removing knockout

3. Punch out desired knockout location
  - a) Insert flat head screwdriver into slots in red and punch through (see note 1)
  - b) Punch through the outer ring, shown in blue, for one pie slice (see note 2)
  - c) Skip one slice and repeat step B for the next slice
  - d) Repeat until all slices have been removed
  - e) Deburr edges
4. Install conduit fitting (not included)
5. Feed cable through conduit fitting

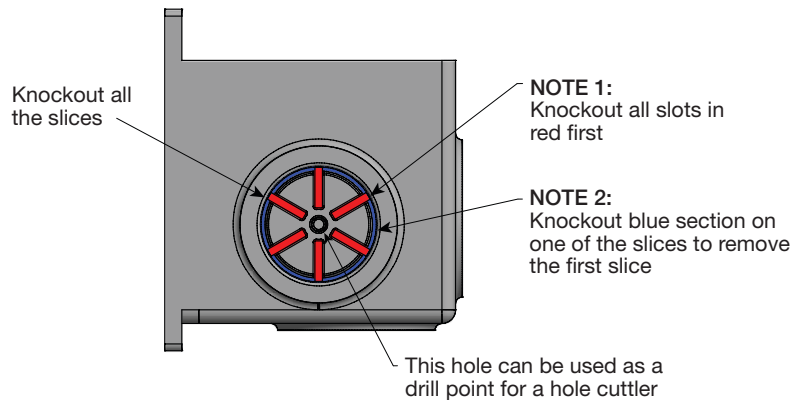
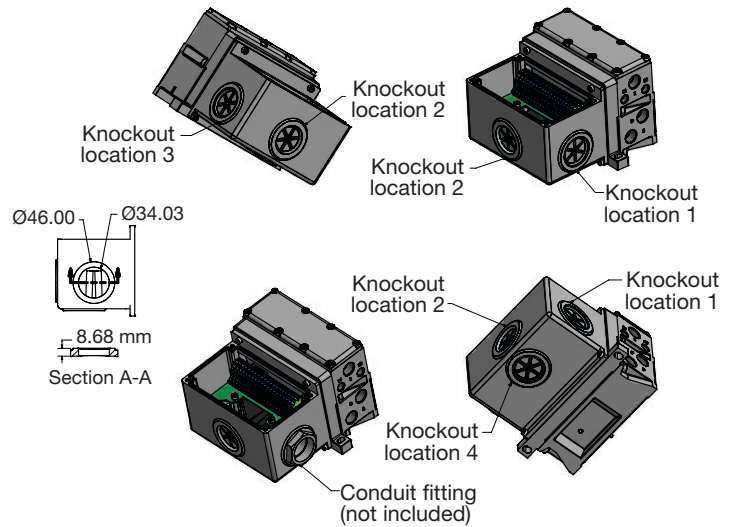

6. Install all wires into the cage clamp terminals
  - a) See the schematic for the terminal designations
  - b) The blue terminals are the drivers for each valve, the green terminal is earth ground, and the gray terminals are common

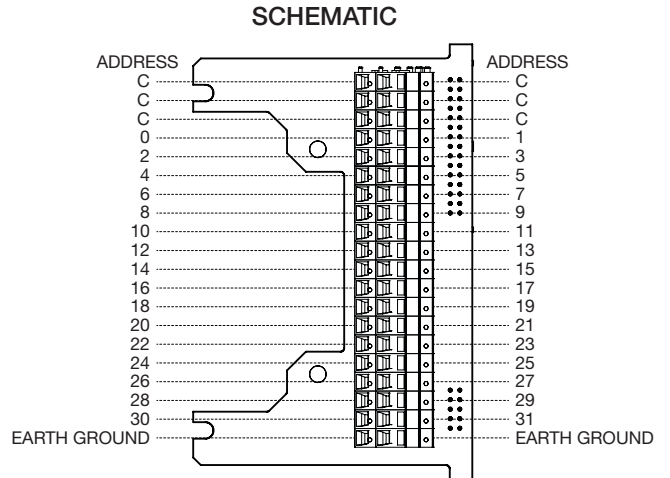
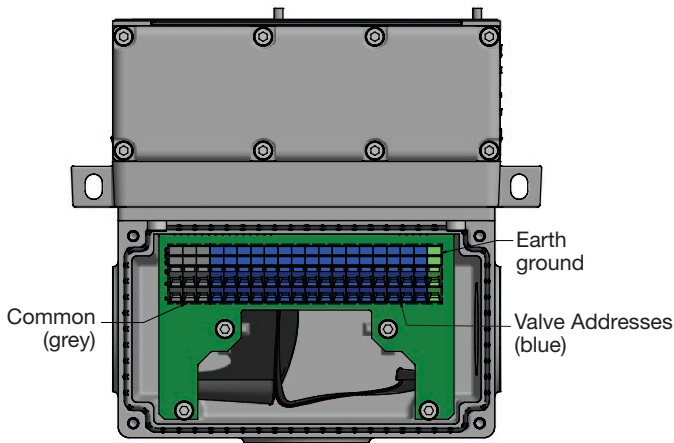

7. Assemble the cover to the top of the box using (4) M4 screws (Item 1c). Ensure the gasket is in place before assembly of the cover (Item 3).

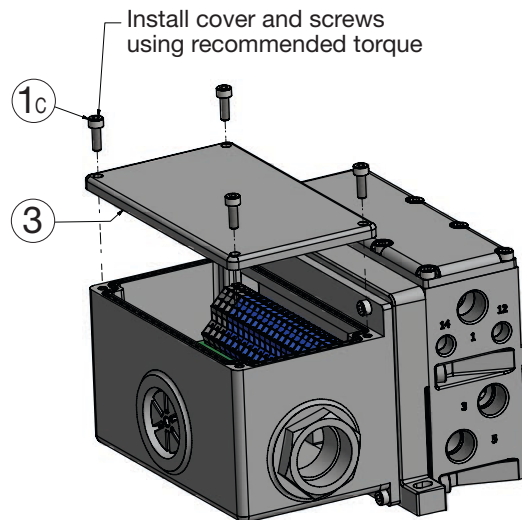

### Removal and assembly of the terminal board - Optional

1. Remove (4) M4 screws (Item 1A) that are used to attach the terminal box to the left endplate

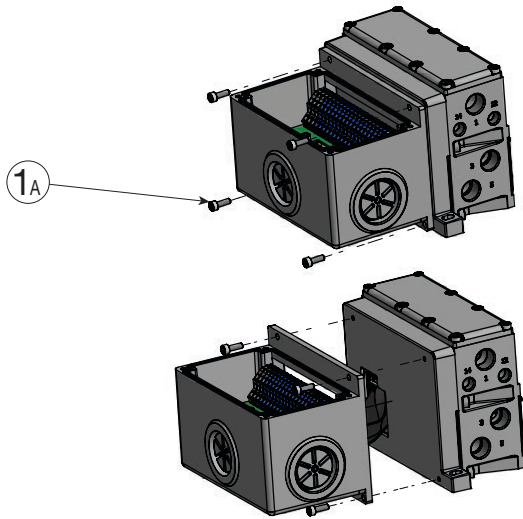

2. Remove 10 pin and 30 pin connectors from the terminal board

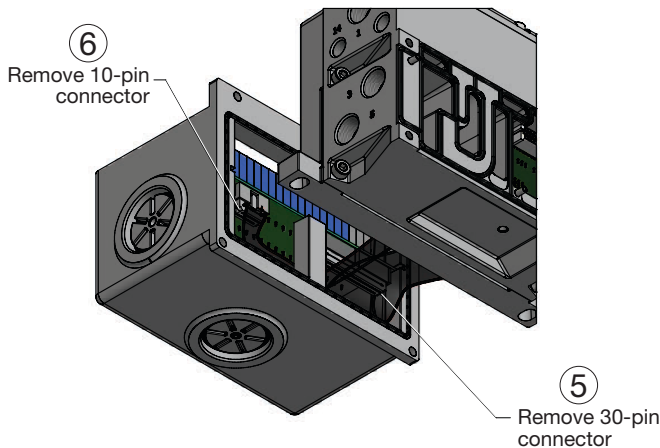

3. Remove (4) M4 screws (Item 1B) that are used to attach the PCB into the box and slide the board out of the box

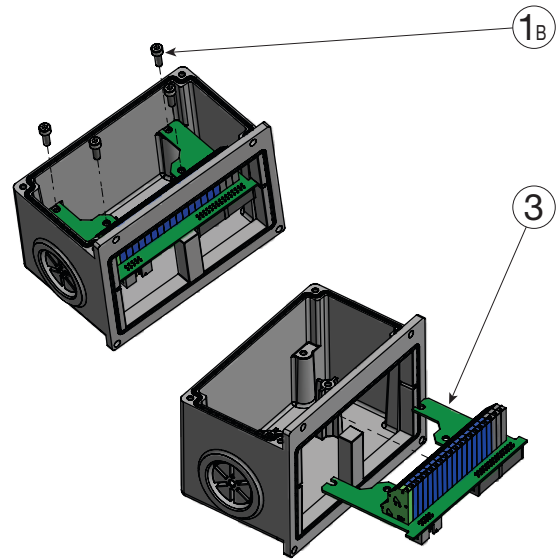

4. Follow steps 3 through 5 on page 3, in the assembly techniques, with the board removed
5. Assemble the 4 M4 screws (Item 1B) back into the board using the torque 15-20 lb-in provided

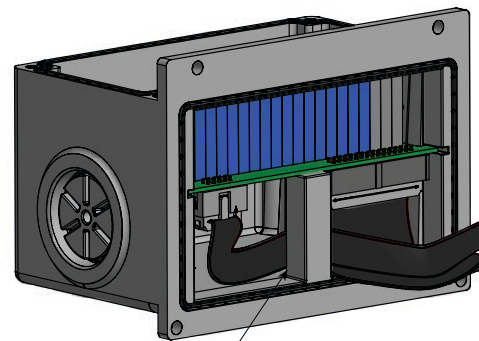

**NOTE 1:**  
When reassembling the 10-pin ribbon cable, make sure it is routed behind the post

6. Insert 10-Pin Ribbon cable connector (Item 6) into the 10-Pin connector on the board (see note 1)
7. Insert 30-Pin Ribbon cable connector (Item 5) into the 30-Pin connector on the board
8. Assemble the box to the Left End Plate using (4) M4 screws (Item 1B)
9. Continue with steps 6 and 7 on page 4, in the assembly techniques

### For all Instruction Sheets, go to [www.parker.com/pneumatic](http://www.parker.com/pneumatic)

V450P - H Series HA 26mm & HB 18mm ISO 15407-2 Valve Service  
 V452P - H Series HA & HB ISO 15407-2 Sandwich Flow Controls  
 V454P - H Series HA & HB Sandwich Regulators  
 V467P - H Series H1 Sandwich Regulators  
 V468P - H Series H1, H2 & H3, ISO 5599-1, 5599-2 Sandwich Flow Controls  
 V470P - H Series H1, H2 & H3, ISO 5599-1, 5599-2 Valve Service  
 V471P - H Series H2 & H3 Sandwich Regulators

V751P - H Series, Terminal Block  
 V752P - H Series, P2M Node  
 V753P - H Series, Turck Network  
 V754P - H Series, H Series Network  
 V755P - H Series, Multi Pin  
 V756P - H Series, Manifold Installation  
 V757P - H Series, P2H IO-Link Module